

Alula RE110P (Wireless Motion)

Compatible Alarm Systems:

Alula Connect Plus

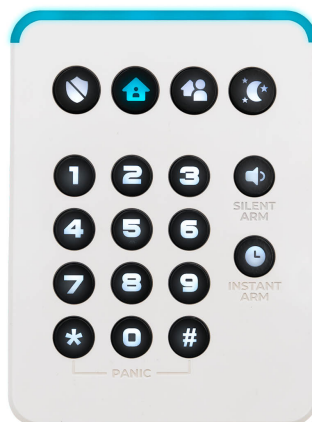
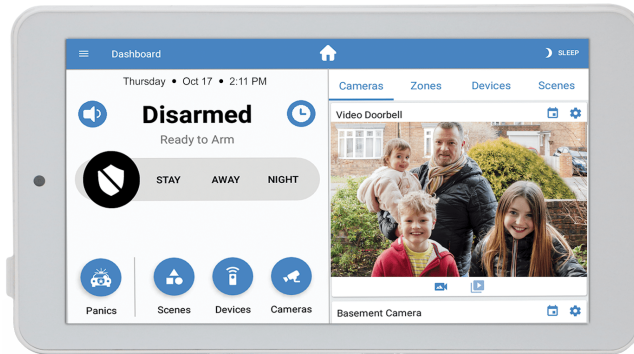

Alula RE110P (Wireless Motion)

1. Motion detectors are generally mounted with 2 screws in the wall. Proceed with caution when removing cover.



2. Locate the push tab underneath, you will need to use a flathead screwdriver to push it in. You will pull the cover toward you, bottom side first.

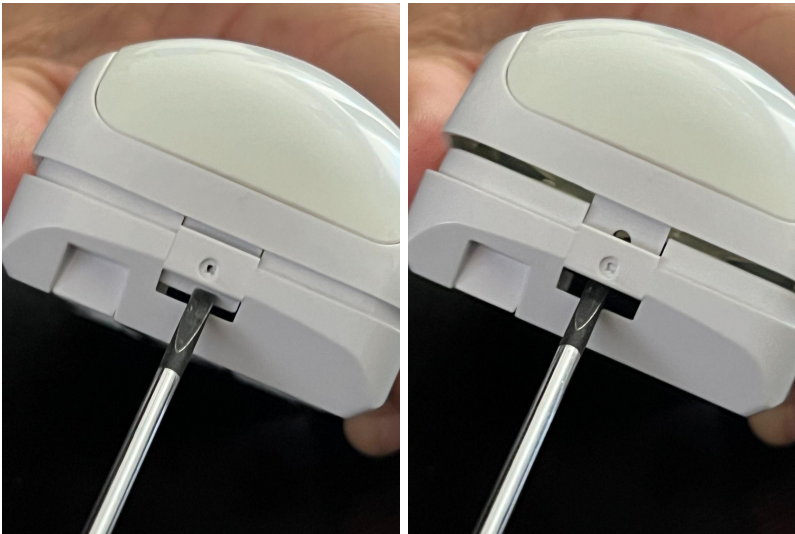

Alula RE110P (Wireless Motion)

3. Remove and replace the battery (1 - CR123. Recommend Lithium). You may need a flathead screwdriver to assist you.

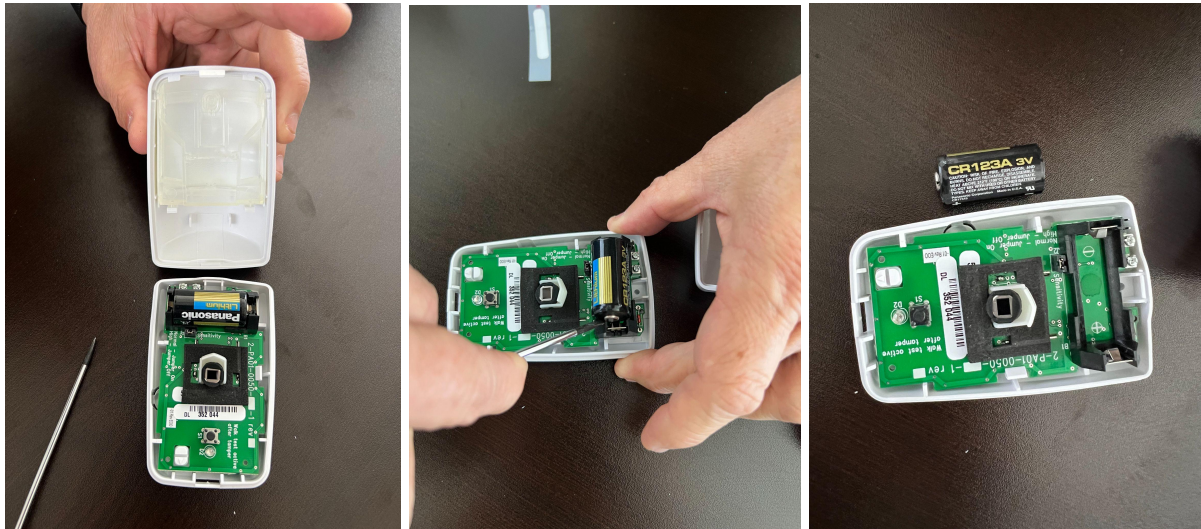

4. Please make sure the positive and negative sides are in the right position. In the photo below, the battery slot has the symbols

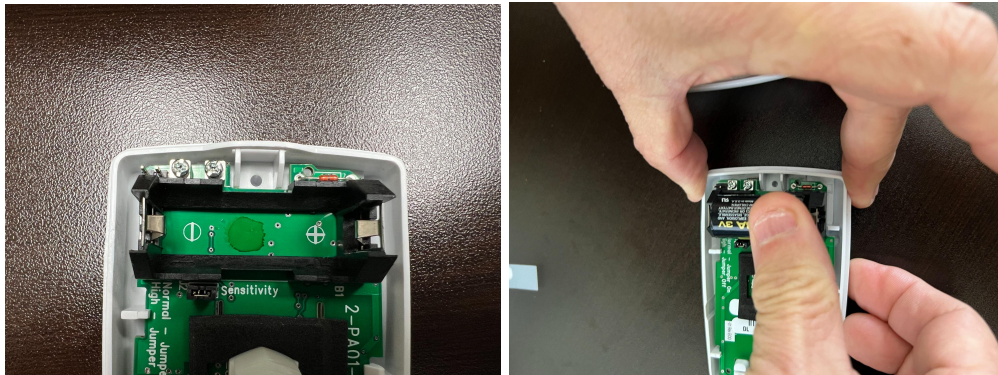

5. Place cover back on. The top side will go in first and then you will push it close to lock the cove back on. Give the system some time and it will reset the low battery.